



Bloomsbury Street, Cheltenham, GL51 8PG

£285,000

🛏 3 🚿 1 🚿 1



- Three bedrooms
- End of terraced house
- Open plan living/dining area
- Separate kitchen area
- Downstairs WC
- Family bathroom
- Enclosed courtyard
- One allocated parking space
- Close to Winston Churchill Memorial Gardens
- Council Tax Band: B



A well presented, three bedroom end of terraced terrace family home. This home benefits from living/dining room, separate kitchen area, downstairs WC, three bedrooms and a family bathroom.

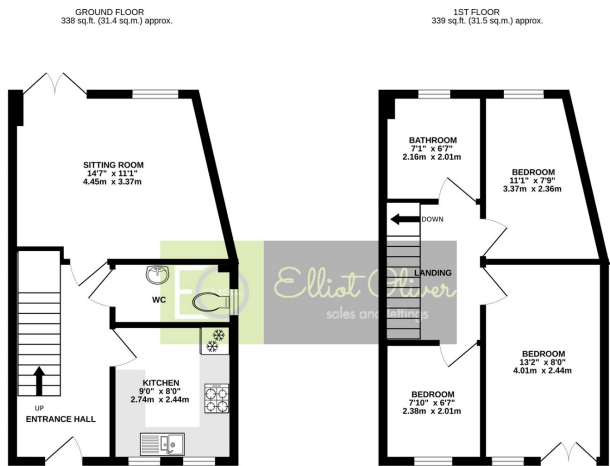

TOTAL FLOOR AREA : 677 sq.ft. (62.9 sq.m.) approx.
While every attempt has been made to ensure the accuracy of the information contained herein, measurements of doors, windows, rooms and any other items are approximate and no responsibility is taken for any error, omission or misstatement. This plan is for guidance purposes only and should be used as a guide only. Prospective purchasers should verify the accuracy of the information contained herein and should not rely on it as a basis for any decision. The information is provided for guidance only and should not be used as a basis for any decision. Please visit www.elliotoliver.co.uk

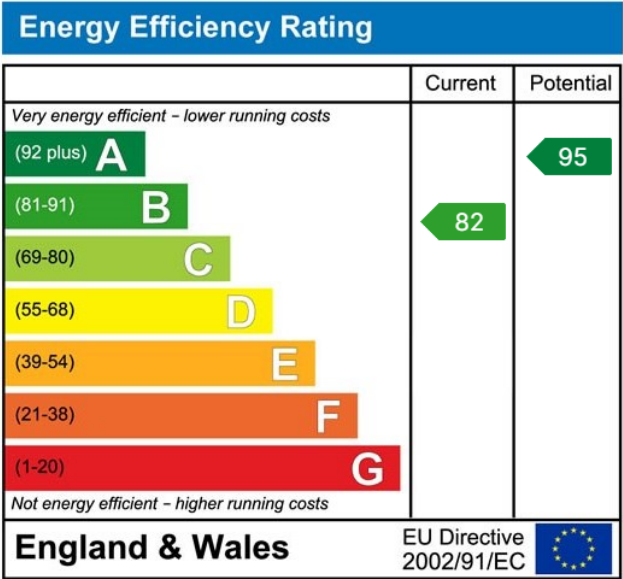

Elliot Oliver Sales

101 Promenade, Cheltenham GL50 1NW
01242 321091
www.elliotoliver.co.uk

